

Automatic

Drifting Laser VL-40, VL-50



Lining up on your target

- 1 Laser receiver**
- 2 Positioning device**
- 3 Drifting laser**
- 4 Remote control**

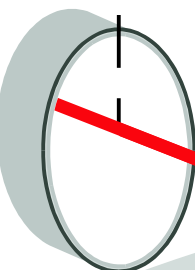
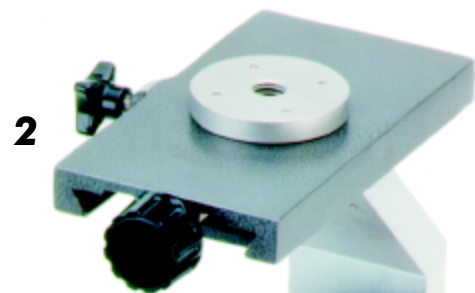

Automatic drifting laser VL-40 / VL-50

A systematic further development of our proven GEO drifting lasers VL-10 - VL-30.

VL-40

- Electronic self-levelling over longitudinal and lateral axes
- Motor-driven direction and inclination adjustment
- Digital inclination reading
- Monitoring system with control display and blinking warning function for self-levelling, operating status and undervoltage
- Special laser beam quality
- VLPH positioning device, suspended
- VLFB remote control for direction adjustment and focussing

VL-50 like VL-40

- + Automatic directioning by way of a second laser beam in conjunction with VLLE laser receiver
- = Increased operating convenience and greater accuracy

Focussable laser beam

Prerequisite for short and long-distance driving.

Robust metal housing

Plastic-coated, filled with nitrogen, 100% watertight, dimensions on the drifting axis only 140 mm.

Flexible power supply

12 V DC and 230 V AC by rechargeable battery / energy box EB-12/24 or power unit NE-12.

Perfected design

Excellent handling, high functional efficiency and operational reliability.

Technical specifications

Laser type: He-Ne continuous wave visible red, 632.8 nm
 Laser class: 3B according to DIN EN 60825-1 / IEC 825-1
 Output main beam: ≤ 3 mW
 Output secondary beam: ≤ 1 mW
 Main laser beam: focussable
 Range depending on ambient conditions: up to 600 m
 Secondary laser beam: direction fixing (only VL-50)
 Distance between VL-50 and VLLE: 2 to 15 m
 Power supply: 12 V DC / 0.8 A
 Reverse voltage protection: yes
 Undervoltage cut-out: display by yellow LED
 Self-levelling range: $+14\%$ / -9% , 2 axes
 Direction setting range: $\pm 5\%$ (10 m over 100 m)
 Inclination adjustment range main beam: $+29\%$ to -22%
 Inclination adjustment range secondary beam: 1% to 373% (75°)
 Smallest reading: 0.01 %, estimated 0.005 %
 Watertight: 0.35 bar
 Temperature range: -10°C to $+50^\circ\text{C}$
 Dimensions: $\varnothing 140 \times 345$ mm
 Weight: about 3.7 kg
 Guarantee: 12 months

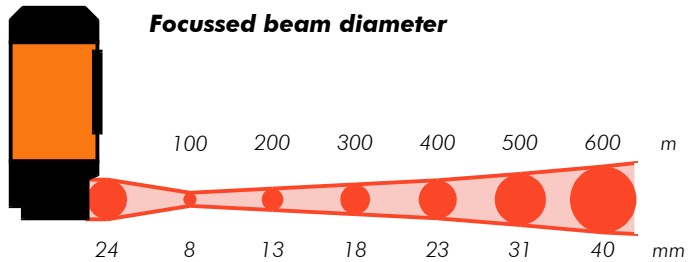

VL-40

with positioning device, standing

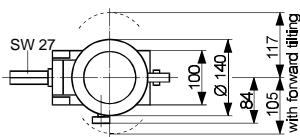
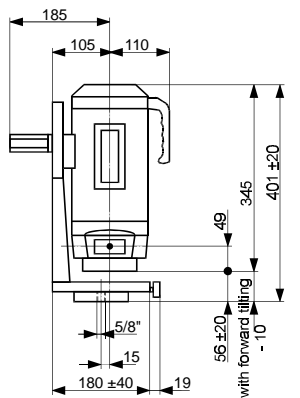

VL-50

with positioning device, suspended

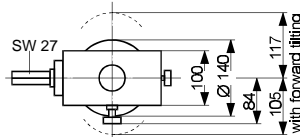
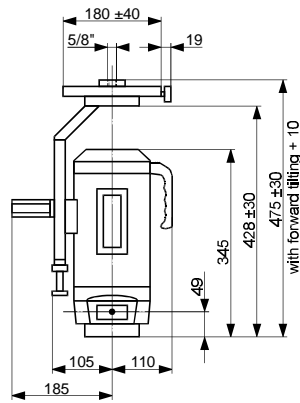

Delivery package

Order no.	Description	VL-40	VL-50
	X = Standard equipment, O = Optional extra		
0001.47 VL-40	Drifting laser	X	
0001.48 VL-50	Drifting laser		X
0024.00	Plug-and-socket spigot adapter, d = 65 mm	O	O
0026.02 VLFB	Remote control for direction adjustment and focussing with integrated horn	X	X
0031.08	Connection cable, 2.5 m, 2 <-> 3-pin	X	X
0037.00 NL-12	Power and charging unit	O	O
0037.01 NE-12	Power unit with connection cable, 2 m	O	O
0038.00	Connection cable, 2.5 m, NL-12 <-> laser	O	O
0047.00	Rechargeable battery connection C	X	X
0048.01 EB-12/24	Energy box, 12 V / 24 Ah	O	O
0053.00	Forward tilt adapter	O	O
0058.00	Tripod height adjustment	O	O
0062.00 VLPH	Positioning device, suspended	X	X
0065.00 VLLE	Laser receiver	X	
0068.00	Intermediate ring for blind hole fastening	O	O
0071.00 VLPS	Positioning device, standing	O	O
0074.02	Connection cable, 20 m, 10-pin, VL-50 <-> VLLE	X	
0074.14	Connection cable, 15 m, 6-pin, VL <-> VLFB	X	X
0077.08	Transport case for laser and accessories	X	X
0095.00.1	5/8" threaded spindle with 3 x 5/8" hex nuts	X	X

GEO - your partner in the construction industry for more than 30 years.

From

GEO-Feinmechanik GmbH

Laser für Hoch-, Tief- und Innenausbau, Maschinensteuerung, Vermessungsgeräte

Postfach 130164
45445 Mülheim an der Ruhr

Solinger Str. 8
45481 Mülheim an der Ruhr

Telefon 0208 / 993570
Telefax 0208 / 9935725

www.geo-laser.de
geo-team@geo-laser.de